

FLUANCE®

RT87

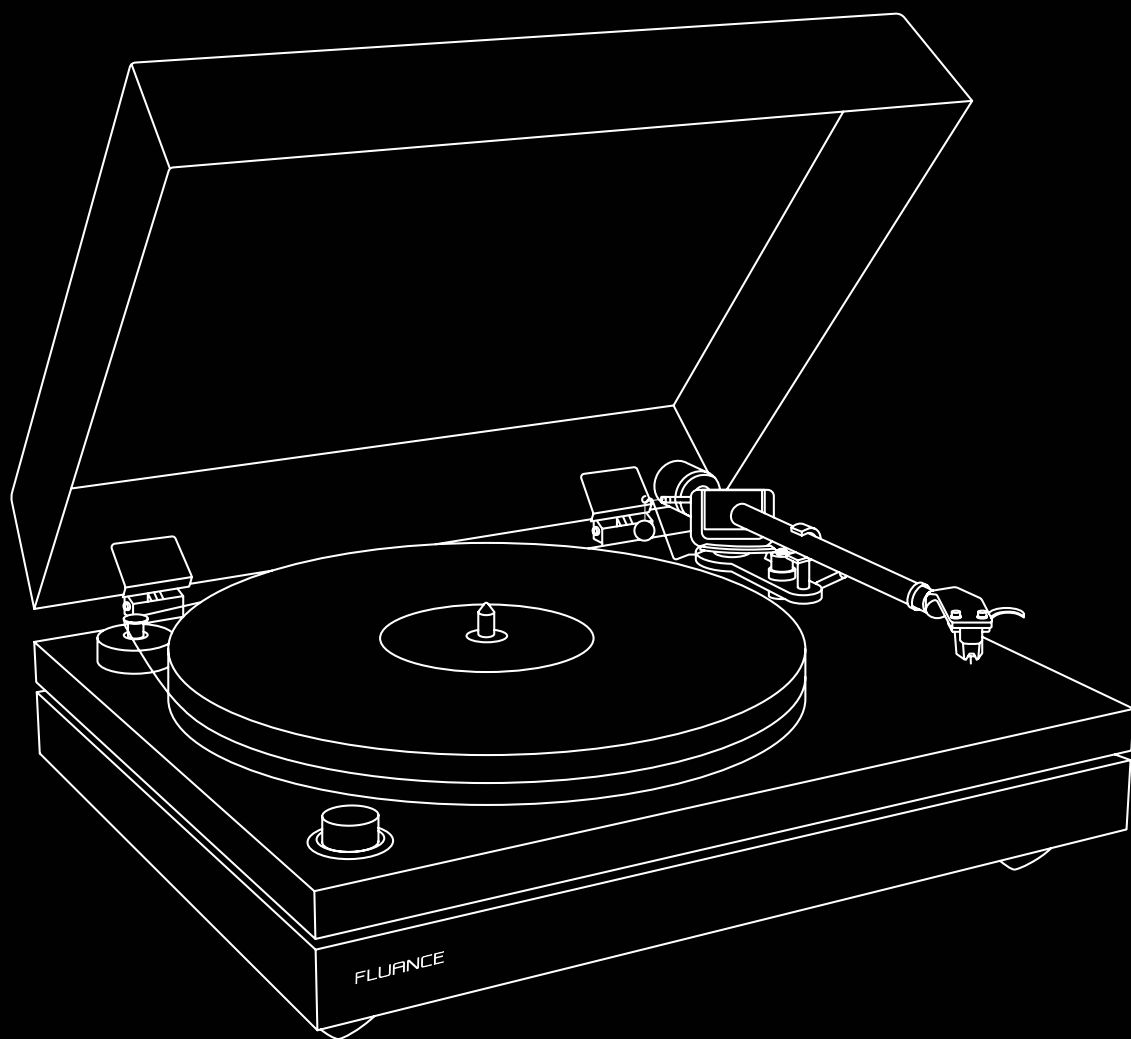

Reference High Fidelity Vinyl Turntable
User Manual v1.0



Serious Performance™

Fluance.com

Important Safety Instructions

1. This unit has been designed and manufactured to ensure your personal safety. Use only for its intended use as described in this manual. Improper use can result in potential electrical shock or fire hazards. Read all safety and operating instructions carefully before installation and use. Keep these instructions for future reference. Take special note of all warnings listed in these instructions and on the unit.
2. Use only a mild cleaning solution and a clean, soft cloth. Always turn the product off before cleaning.
3. To reduce the risk of fire or electric shock, do not expose this apparatus to rain, water, or moisture. The apparatus shall not be exposed to dripping or splashing and that objects filled with liquids, such as vases, shall not be placed on apparatus. Do not place or store the apparatus where it can fall or be pulled into a tub or sink. Do not reach for unit that has fallen into water. Unplug it immediately.
4. Only use attachments/accessories/replacement parts as specified by the manufacturer. Ensure that the power voltage stated on the rating label corresponds to your local electricity supply.
5. The symbol with  indicates AC voltage.
6. The symbol with  indicates DC voltage.
7. Do not defeat the safety purpose of the polarized or grounding plug. A polarized plug has two blades with one wider than the other. A grounding plug has two blades and a third grounding prong. The wide blade or the third prong is provided for your safety. If the provided plug does not fit into your outlet, consult an electrician for replacement of the obsolete outlet.
8. Protect the power cord from being walked on or pinched particularly at the plugs, convenience receptacles, and at the point where they exit from the apparatus. Never operate this unit if it has a damaged cord or plug, if it is not working properly, if it has been dropped or damaged, or dropped into water. If the unit's power supply cord or plug is damaged, do not attempt to fix it yourself. Only use a power supply of the type described in this manual, or that is marked on the unit.
9. Do not overload electrical outlet. Use only the power source as indicated.
10. The mains plug is used as disconnect device, the disconnect device shall remain readily operable.
11. Unplug the apparatus during lightning storms or when unused for long periods of time.
12. Do not install this unit in places exposed to direct sunlight or close to heat radiating appliances such as electric heaters, on top of other stereo equipment that radiates too much heat, places lacking ventilation or dusty areas, places subject to constant vibration, and/or humid or moist areas.
13. Never expose this product to extremely high or low temperatures. Using the product in a 0-35°C environment is recommended. Shipping and storing the product in a 0-35°C environment is recommended.
14. Do not install this equipment in a confined space and maintain good ventilation conditions. The ventilation should not be impeded.
15. Do not block any ventilation openings. Install in accordance with the manufacturer's instructions.
16. Refer all servicing to qualified service personnel. Servicing is required when the apparatus has been damaged in any way, such as power-supply cord or plug is damaged, liquid has been spilled or objects have fallen into the apparatus, the apparatus has been exposed to rain or moisture, does not operate normally, or has been dropped.
17. The exclamation point within an equilateral triangle is intended to alert the user to the presence of important operating and maintenance (servicing) instructions in the literature accompanying the unit.
18. This lightning flash with arrowhead symbol within an equilateral triangle is intended to alert the user to the presence of non-insulated "dangerous voltage" within the product's enclosure that may be of sufficient magnitude to constitute a risk of electric shock.

Introduction

Thank you for your purchase of your Fluance product. We hope you enjoy your experience. If you have any questions please visit us at Fluance.com/support.

Fluance believes everyone should experience audio in its truest form, recreating the performance the way the artist intended. Utilizing only superior components and expert audio engineering, their products are a testament to the performance that can be achieved when a passion for music takes center stage. The perfect complement to any audiophile's lifestyle, you'll be enjoying live performances in your home for years to come.

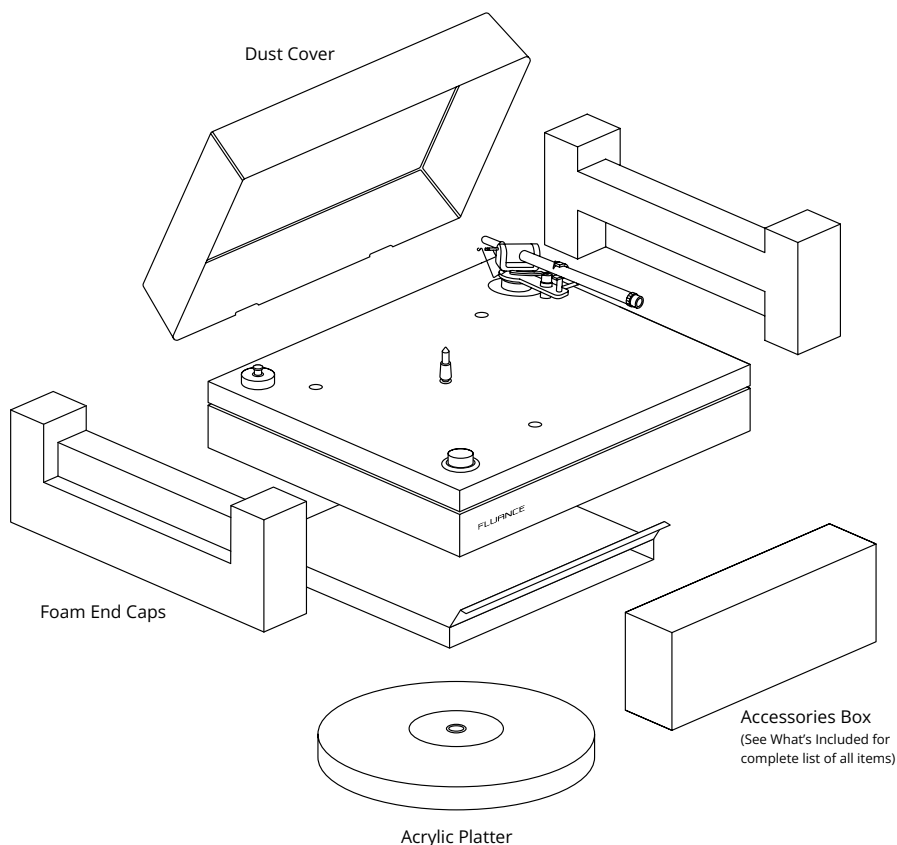

Need Help?

Scan this QR Code for easy setup instructions, videos, and frequently asked questions.



Fluance.com/resources



Fluance.com/contact



Fluance.com/support

Don't forget to register your product with us! Fluance.com/registration

Table Of Contents

Introduction	3
What's Included	5
Components and Connections	6
First Time Setup	7
Step One: Removing the Shipping Protection	7
Step Two: Installing the Counterweight	9
Step Three: Installing the Headshell	9
Step Four: Balancing the Tonearm	9
Step Five: Installing the Anti-Skate Weight	10
Step Six: Installing the Platter	10
Step Seven: Installing the Dust Cover	11
Step Eight: Leveling the Turntable	11
Step Nine: Connecting the RCA & Ground Cables	12
Step Ten: Connecting the Power Adapter	13
Step Eleven: Playing a Record	13
78 RPM Playback	13
Maintenance	14
Replacing the Stylus	14
Replacing the Rubber Belt	14
Upgrading the Cartridge	14
Adjusting Tonearm Height	15
Parts and Accessories	16
Turntable Care	16
Record Care	16
Stylus Care	16
Troubleshooting	17
Warranty Information	20
FCC & IC Information	21
Cartridge Alignment Protractor	22

What's Included

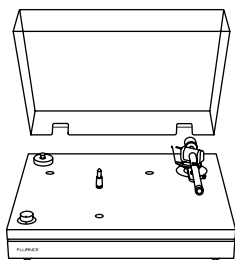

Turntable with Dust Cover

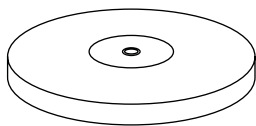

Acrylic Platter

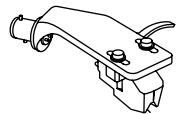

Headshell with Stylus

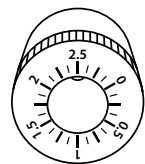

Counterweight

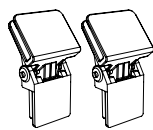

Dust Cover Hinges

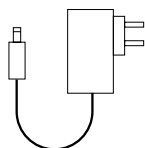

Power Adapter

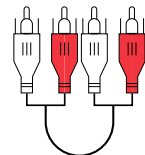

RCA Audio Cable

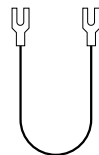

Ground Cable

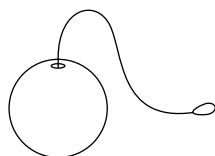

Anti-Skate Weight



Hex Wrench



Transit Screw Hole Covers (3x)

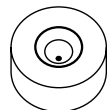

Bubble Level

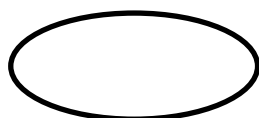

Rubber Belt

Components and Connections

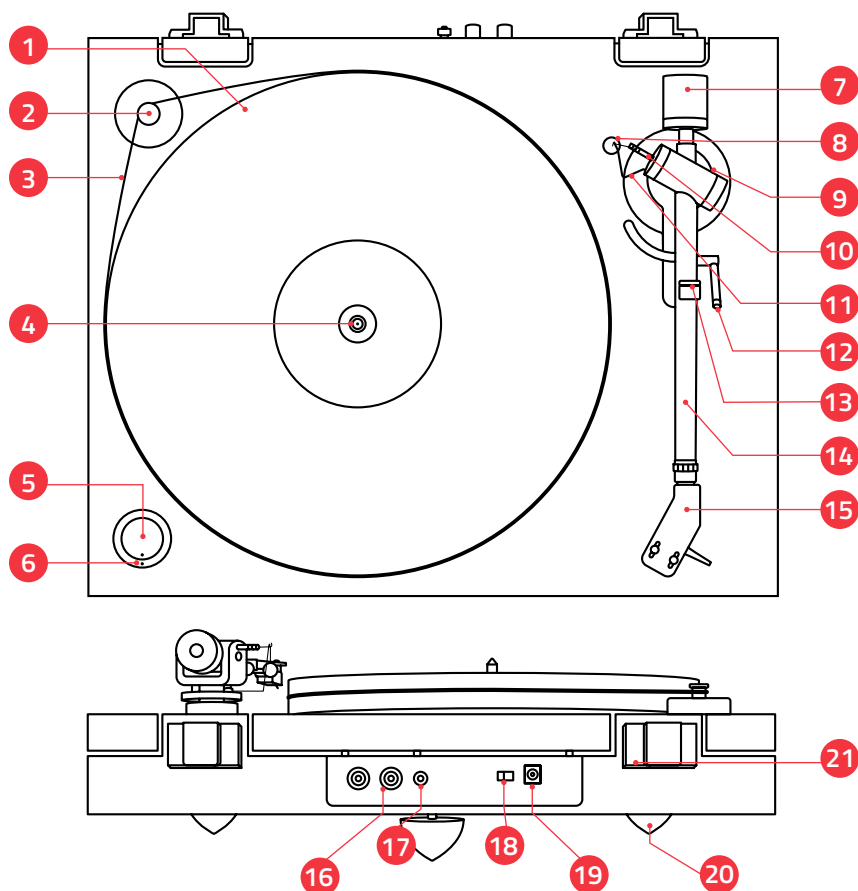

- | | |
|------------------------------------|-----------------------------|
| 1. Platter | 11. Anti-Skate Hanger |
| 2. Motor Pulley | 12. Cueing Lever |
| 3. Rubber Belt | 13. Tonearm Lock |
| 4. Spindle | 14. Tonearm |
| 5. Speed Selection (33/45/78) | 15. Headshell & Stylus |
| 6. Power LED | 16. RCA Audio Outputs |
| 7. Counterweight | 17. Ground Terminal |
| 8. Anti-Skate Weight | 18. Auto-Stop Switch |
| 9. Tonearm Height Adjustment Screw | 19. Power Input |
| 10. Anti-Skate Mounting Post | 20. Isolation Feet |
| | 21. Dust Cover Hinge Mounts |

First Time Setup

Step One: Removing the Shipping Protection

1. Place the turntable on a sturdy surface. Loosen and remove the three transit screws from the plinth. This will release the upper plinth from the lower plinth.
2. Install the included Transit Screw Covers on each empty hole. The removed screws should be stored in the provided envelope for future use.

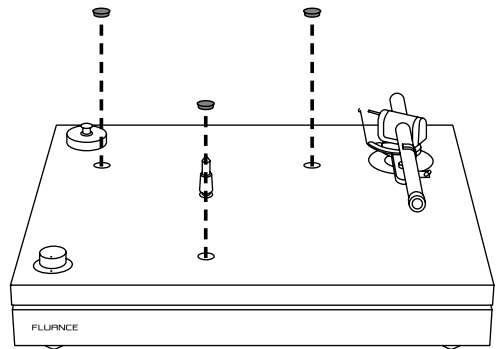
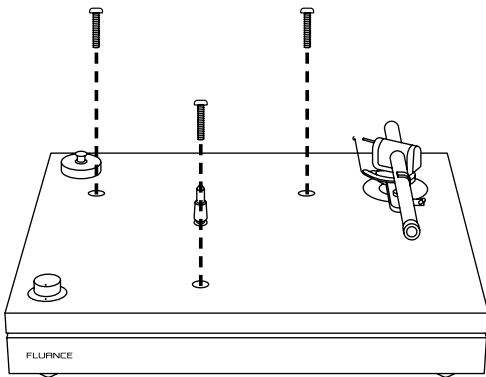

3. Remove the Tonearm Transit Spacer by gripping it firmly and pulling towards the back of the turntable.

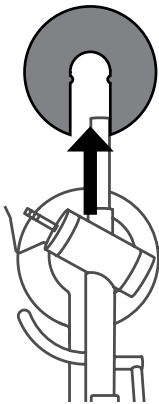

Step Two: Installing the Counterweight

1. Secure the tonearm using the tonearm lock.
2. Slide the counterweight onto the end of the tonearm with numbers facing forward.

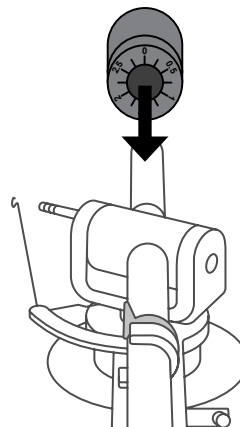
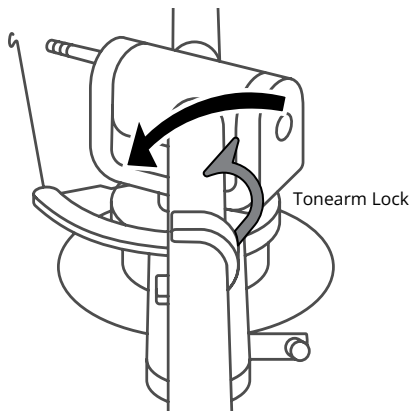

Step Three: Installing the Headshell

1. Remove the headshell from the protective packaging and insert into the end of the tonearm.
2. Tighten the locking nut until the headshell is secure.

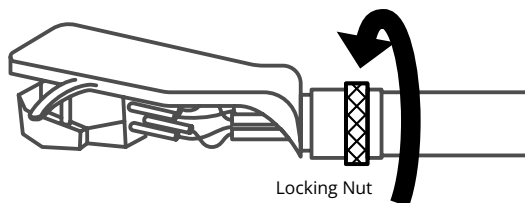
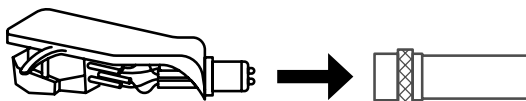

Step Four: Balancing the Tonearm

1. Remove the stylus protector.
2. Unlock the tonearm and lift the cueing lever.

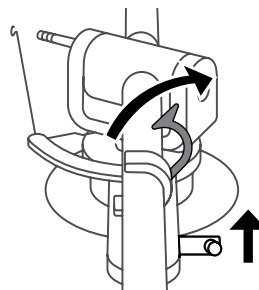

3. Position the tonearm over the plinth as shown below.

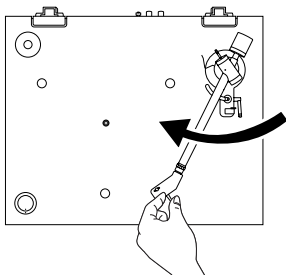

4. Hold the headshell and lower the cueing lever completely.

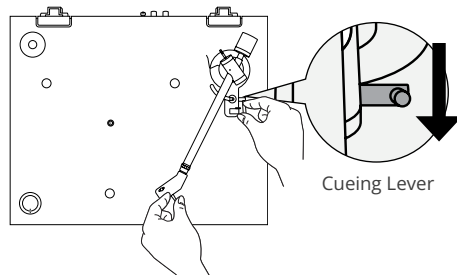

5. With the cueing lever now lowered, turn the entire counterweight until the tonearm is balanced and floating horizontally when headshell is released.

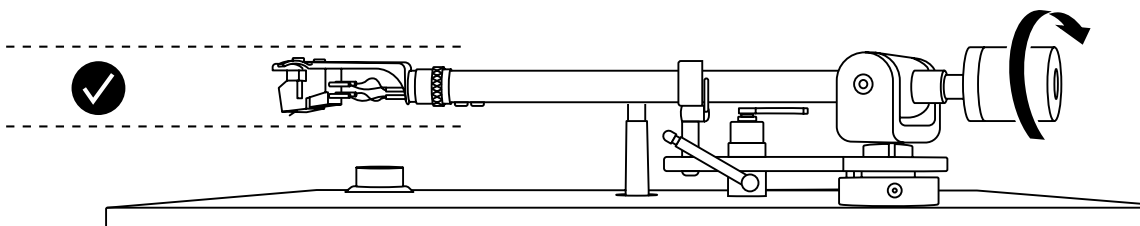

6. Set **only** the counterweight indicator ring to "0" on the center line while keeping the tonearm balanced, then lock the tonearm on the tonearm rest.

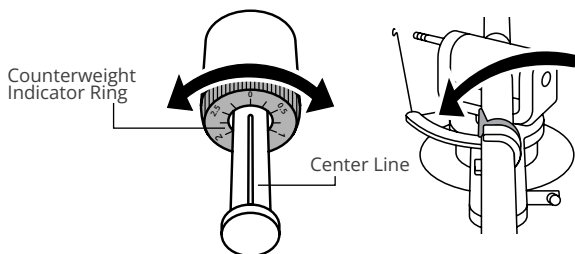

7. Rotate the entire counterweight counterclockwise until the indicator ring is set to 2.0 g on the center line.

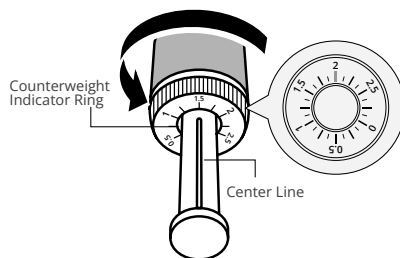

Step Five: Installing the Anti-Skate Weight

1. Install the anti-skate weight by placing the loop around the anti-skate mounting post and then hang the string over the anti-skate hanger. The mounting post has 3 notches that allow the user to set the correct anti-skating force. The default position for the RT87 is on the **second notch**.

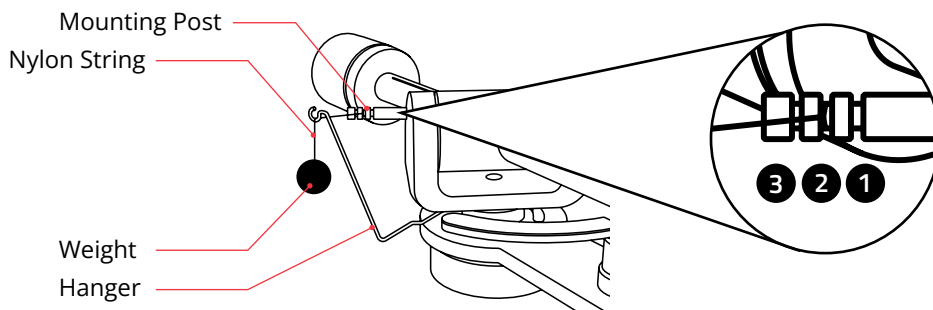

Step Six: Installing the Platter

1. Place the platter on the spindle located in the middle of the turntable.
2. Place the rubber belt onto the outside edge of the platter and rotate the platter until the belt is fully installed around the platter. Be careful not to overstretch the belt when installing.

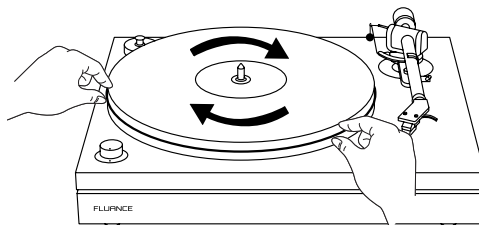
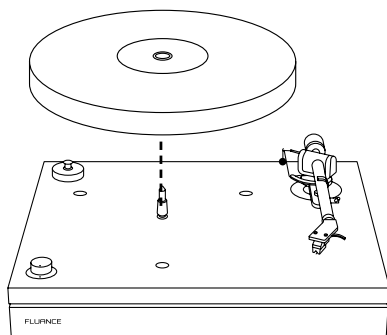

3. Lift the rubber belt and place it around the motor pulley. Rotate the platter several times to ensure the rubber belt is secure and not twisted.

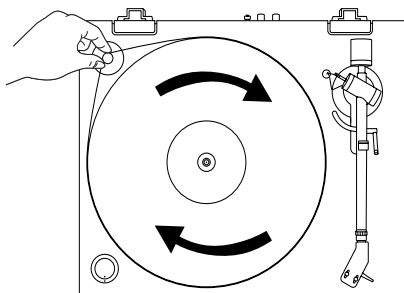

Step Seven: Installing the Dust Cover

1. **Important:** Place dust cover on a soft surface to avoid scratching it. Install the hinges on the provided grooves located on the back of the dust cover.
2. Carefully open the hinges on the dust cover and insert into the pre-installed hinge mounts on the back of the turntable.

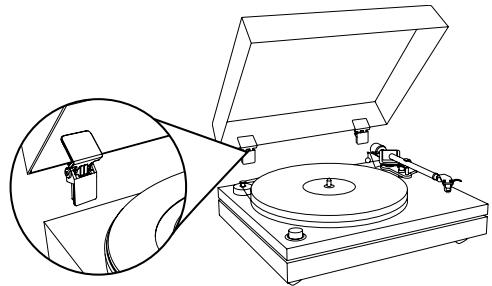
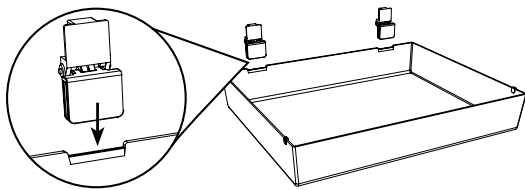

Step Eight: Leveling the Turntable

1. This turntable features 3 adjustable feet to ensure the turntable is level regardless of the surface the turntable is resting upon. Place the bubble level on the plinth and adjust the feet until the bubble is entirely within the circle.

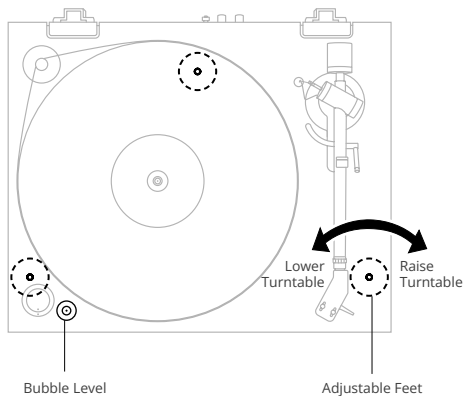

Step Nine: Connecting the RCA and Ground Cables

1. This turntable does not have an internal preamp, so an external preamp or an amplifier with a PHONO input must be used. Connect the RCA and ground cable to the back of the turntable and then connect the other ends to your external preamp or the PHONO input and ground terminal on your amplifier. Ensure the cable colors are matched to the RCA connector colors.

Note: The included RCA cable is a high quality cable with a <90pF capacitance rating. For best performance it is recommended that any other RCA connections use a similarly rated cable. The Fluance RCA cable is available at www.fluance.com/turntable-accessories

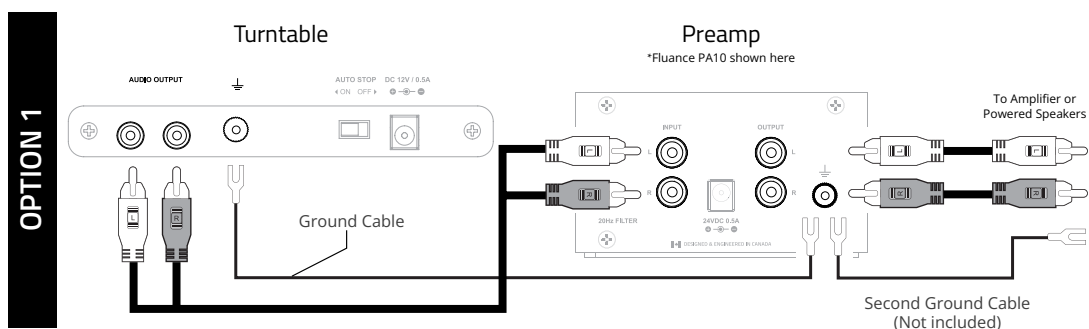

Important: When using an external preamp one ground cable should be connected between the turntable and the preamp. A second ground cable (not included) should be connected between the preamp and the amplifier/powered speakers. Failure to connect both ground cables can result in unwanted noise/hum.

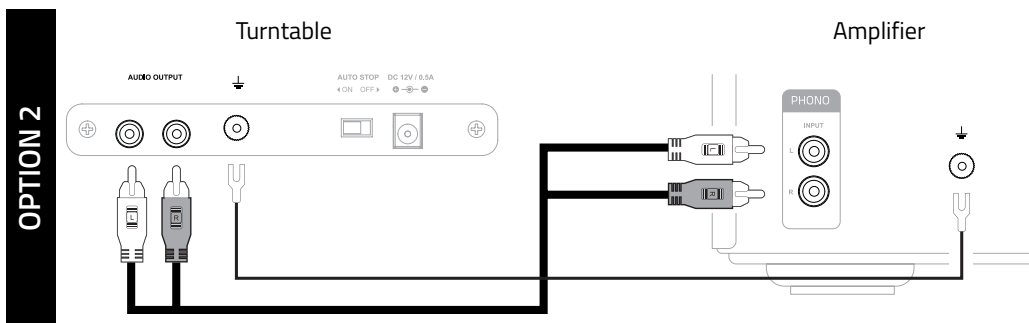

Important: The ground cable must be connected to both turntable and amplifier. Failure to connect to both can result in unwanted noise/humming.

Step Ten: Connecting the Power Adapter

Insert the power cable into the power input on the back of the turntable. Ensure the power adapter is securely connected to a power outlet. It is recommended to reconfirm with the bubble level that the turntable is still level after setup is complete.

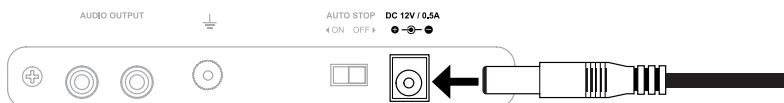

Important: Only use the official power adapter included with your turntable.

Step Eleven: Playing a Record

1. Lift the dust cover
2. Place a record on the spindle (use a 45 adapter if necessary)
3. Turn the speed selection knob to the correct RPM typically listed on your record (Normal LP playback speed is 33 RPM)
4. Unlock the tonearm lock
5. Lift the cueing lever
6. Move the tonearm to the desired starting point
7. Lower the cueing lever

78 RPM Playback

Most records that play at 78 RPM are made from shellac instead of vinyl. Shellac is a harder material and can cause excessive wear and tear on standard stylus tips. To avoid this, it is recommended to always use a cartridge/stylus that is designed for 78 RPM playback.

Break-In Period

To experience peak performance of your turntable, it is recommended to allow the cartridge to break in. The break-in period for cartridges included with Fluance turntables is 20 hours of normal playback.

Auto-Stop Function



The auto-stop function is designed to extend the life of your stylus. Approximately 40 seconds after the end of a record, the platter will automatically stop spinning if auto-stop is enabled. Due to variances in vinyl record production, some records may not work correctly with the auto-stop function.

When enabled, this feature will require that the tonearm is moved over the record before the platter will start spinning at the selected speed. If the auto stop switch is set to the OFF position, the platter will begin spinning as soon as the speed selection knob is set to 33, 45, or 78. To stop the record from spinning, set the speed selection knob to the OFF position.

Maintenance

Replacing the Stylus

Use the chart below to ensure you replace your stylus with the correct model. Replacement stylus and instructions are available at www.fluance.com/turntable-accessories

Model	Cartridge	Stylus
RT87	AT-VM95ML	AT-VMN95ML



Replacing the Rubber Belt

1. Keeping the platter installed, remove the defective rubber belt from the motor pulley and platter.
2. Wrap the new rubber belt around the platter being careful to not overstretch the belt. Ensure it is not twisted.
3. Lift the rubber belt and place it over the motor pulley.
4. Rotate the platter several times to ensure the rubber belt is secure and not twisted.

Upgrading the Cartridge

The turntable supports the option of upgrading the cartridge. A cartridge replacement guide and video are available at www.fluance.com/resources
There is also a Cartridge Alignment Protractor at the end of the manual for your convenience.

Cartridge Connections

Wire	Channel
White	Left (+)
Blue	Left (-)
Red	Right (+)
Green	Right (-)

Turntable Cartridge Specifications

Effective Tonearm Mass	16 g
Overhang	18.5 mm
Effective Tonearm Length	230 mm
Headshell Cartridge Mount	Half-Inch Mount
Fluance Headshell Weight	7.65g

Maintenance

Adjusting Tonearm Height

This turntable features a tonearm with adjustable height to ensure compatibility with cartridges of different sizes. Follow the “Upgrading the Cartridge” instructions on pg. 14 to install a new cartridge. The tonearm should be rebalanced after the cartridge is changed.

CAUTION: Do not make VTA adjustments with the stylus on the record. Make VTA adjustments only with the tonearm locked.

1. Once the new cartridge installation is complete, lock the tonearm with the tonearm lock and place a record onto the platter.
2. Remove the stylus guard and use the cueing lever to lift and lower the stylus onto the record.

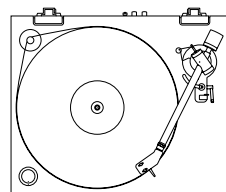
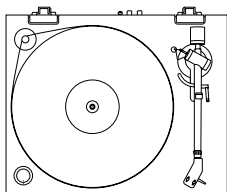

3. The tonearm should be parallel with the record surface when height is set correctly. Note how much of an adjustment is needed and then return the tonearm to the tonearm rest and lock in place.
4. Use the provided hex wrench to loosen the tonearm height adjustment screw on the base of the tonearm.

IMPORTANT: The turntable is shipped with a 2mm spacer installed. The spacer should be removed during initial setup (Step One).

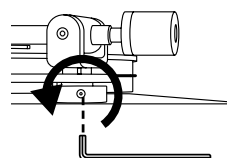
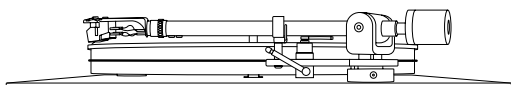

5. Raise or lower the tonearm base and, while holding the tonearm base in position, use the hex wrench to gently tighten the adjustment screw. Avoid overtightening the screw.
6. Unlock the tonearm and place the stylus on the record. Confirm that the tonearm is now parallel with the record surface. If further adjustment is needed repeat steps 3-5 and then check again.

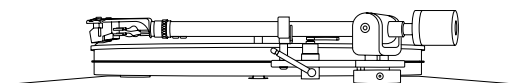
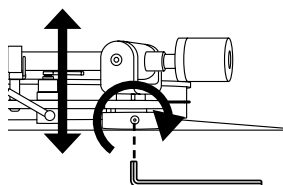

Parts and Accessories

Replacement parts and turntable accessories are available at www.fluance.com/turntable-accessories

Part Number	Description
PA10	High Fidelity Phono Preamp
VB52	Vinyl Record & Stylus Cleaning Kit
BL21	Bubble Level
CA03	90pF RCA Cable
GW03	Ground Wire
HS82	RT82-RT85 Headshell with wires
PFHTDU	Dust Cover
PFHTRP	Rubber Turntable Mat
TA21	Cork Turntable Mat
PM50	Acrylic Turntable Mat

Turntable Care

1. Use a soft dry microfiber cloth to wipe dust from the turntable surface.
2. Keep the dust cover closed to ensure the turntable components remain dust free.
3. When cleaning the acrylic platter only use microfiber cloth to avoid scratching the surface.

Record Care

1. Records should be stored vertically in a dry environment away from sources of heat.
2. An anti-static brush can be used to remove dirt from the record's grooved surface. Use a record cleaning solution to further clean your records to ensure crystal clear playback.
3. It is important to use the cueing lever when lifting or lowering the tonearm to prevent accidental slipping and scratching.

Stylus Care

1. When the turntable is not in use always keep the provided stylus protector installed to prevent accidental damage.
2. A stylus cleaning brush can be used to remove dust and debris from the stylus.
3. Enabling the auto stop function will reduce wear and tear on the stylus by stopping the turntable after playback is completed.

Note: 78 RPM records can cause greater wear and tear on a stylus. For best results it is recommended to use a stylus designed for 78 RPM playback.

Troubleshooting

Turntable Not Spinning

- Turn the speed selection knob to 33, 45, or 78 (power LED should light up). Lift the tonearm over the platter and it should start spinning.
- The turntable should be connected to a known good power outlet and the power cable should be securely inserted into the unit. Only use the official power adapter (12 V 0.5 A) included with your turntable.
- Ensure the rubber belt is intact and installed around the platter and the motor pulley.

No Power

- The turntable should be connected to a known good power outlet and the power cable should be securely inserted into the unit. Only use the official power adapter (12 V 0.5 A) included with your turntable.
- The power LED should light up when the speed selection knob is set to 33, 45, or 78.

Wrong Speed

- Check the record label for the correct playback speed and that the speed selection knob is set to match it. Normal LP playback speed is 33 1/3 RPM, but some play at 45 or 78 RPM.

Skipping

- Ensure the record surface is clear of dirt and debris. Also check that the record is not warped or deformed.
- Inspect the stylus tip for built up dirt or debris. Use a stylus cleaning brush to clean if necessary.
- Ensure the turntable is on a sturdy and level surface and properly leveled using the adjustable feet.
- Use the instructions in Step Four of the first time setup instructions to confirm the tonearm was balanced correctly and set to the correct tracking force for the included cartridge.
- Check that the anti-skate force is set to match the required tracking force for the cartridge.
- Confirm that the tonearm bridge is not in contact with the tonearm when the cueing lever is lowered. See Cueing Lever Not Lowering Tonearm troubleshooting for more details.

Audio Feedback

- If audio feedback occurs ensure the speakers are positioned away from the turntable.
- The turntable should not be placed in front of the speakers or on the same surface as the speakers.
- For best audio performance the dust cover should be removed during playback.

- Playback at excessive volume can cause feedback. If feedback is occurring decrease volume or lower bass levels.
- If using an external preamp with a rumble filter, turn it on to reduce resonance feedback.
- An isolation base (Fluance IB40) can be also added to reduce unwanted vibrations.

Cueing Lever Not Lowering Tonearm

- Use instructions in Step Four of the first time setup instructions to confirm the tonearm was balanced and set to the correct tracking force.
- Lock the tonearm and lower the cueing lever. Gently press down on the tonearm bridge until fully lowered to reset the tonearm lowering mechanism and then test again.

Low Volume

- Check the RCA connections are correct and fully inserted. (See Step Seven)
- If the turntable is directly connected to an amplifier it must have a PHONO input.
- The turntable does not include an internal preamp so an external preamp or amplifier with PHONO input must be used with the turntable. The Fluance High Fidelity Phono Preamp (PA10) is designed for the Reference Series turntables and is available on www.fluance.com.

Humming Sound

- Connect the ground wire to your external preamp or amplifier. If using an external preamp, try using a second ground wire from the preamp to the amplifier/powered speakers.
- Ensure the headshell is fully tightened and secured on the tonearm. (See Step Three)
- The turntable and other devices should be directly connected to a power outlet. It is recommended to avoid power bars or extension cables.
- Ensure the speakers are positioned away from the turntable. The turntable should not be placed in front of the speakers or on the same surface as the speakers.
- Do not place near sources of interference such as routers, receivers, or other electronic devices.
- Remove the dust cover and then test again.

Audio From Only One Channel

- Test the speakers with another device such as a CD Player or Smartphone.
- Confirm the tonearm is balanced and using the correct tracking force.
- Disconnect and reconnect the RCA cables ensuring they are fully inserted.
- Try a different set of RCA cables.
- Remove the headshell from the tonearm and use rubbing alcohol on a cotton swab to clean the contacts on the back of the headshell. Reinstall the headshell ensuring the locking nut is tightened completely.

Need Additional Help?

- Do not return this product to the store.
- Please contact Fluance Customer Experience first, regarding any additional information on product features, specifications or assistance with setup.
- Online web chat or Support: www.fluance.com/contact
- Online support videos and guides: www.fluance.com/resources

Warranty Information

Thank you for choosing Fluance! We guarantee your investment in our products is a solid one. High performance components combined with quality craftsmanship allow us to maintain the highest possible production standards. All items are guaranteed against defects in materials and craftsmanship. Fluance has outstanding quality control; if something should go wrong with any of our products, we will repair it free of charge within the warranty period. If the product cannot be repaired, we will replace the product. If the product has been discontinued, we will replace the product with either the newest version of said product or current equivalent. In the event that Fluance replaces a product under warranty, the replacement would only carry the original warranty from the original date of purchase.

Warranty Period

The Fluance products below are warrantied for parts and labor for the stated period from date of original purchase, and are subject to the terms and conditions of the warranty. Any refurbished products that are discontinued hold a 90 day warranty from the date of original purchase. Fluance warranties are valid for the original owner and are non-transferable.

- Home Audio Passive Speakers: Lifetime Warranty
- Active or Powered Speakers: Two Year Warranty
- HiFi Turntables: Two Year Warranty
- Batteries (For Powered Speakers): One Year Warranty

Warranty Exclusions:

- Products purchased from a dealer not authorized by Fluance.
- Products with the serial number defaced, altered, or missing.
- Defects resulting from disaster, accident, abuse, misuse, lightning, power surges, neglect, unauthorized modification or water damage.
- Defect or damage as a result of repairs performed by a person or party not authorized by Fluance.
- Defects of damage occurring during shipping (claims should be made with the shipping company).
- Defect or damage as a result of connecting a product to an outlet with the incorrect voltage. Voltage converters must be used where applicable.
- Consumable parts including, but not limited to, batteries, styli, and rubber belts.

To Obtain Warranty Service

Should your product require warranty service, please contact us at www.fluance.com/contact or call us at 1-888-617-6863 to set up a Return Authorization. Products returned without a valid Return Authorization number will be refused.

Fluance products must be returned in their original packaging. Our products are packaged specially to protect them from any damage during shipping, and without this packaging the return shipment could get damaged.

This warranty does not cover the shipping cost, insurance, or any other incidental charges. Products shipped for warranty service must be pre-paid by the customer, and Fluance will cover the cost to ship the repaired or replaced product back to the customer.

FCC & IC Information

WARNING: To reduce the risk of fire or electrical shock, do not expose this appliance to rain or moisture. Electrical equipment should NEVER be kept or stored in damp environments.

This equipment has been tested and found to comply with the limits for a Class B digital device, pursuant to Part 15 of the FCC Rules. This digital apparatus does not exceed the Class B limits for radio noise emissions from digital apparatus as set out in the Radio Interference Regulations of Industry Canada.

These limits are designed to provide reasonable protection against harmful interference in a residential installation. This equipment generates, uses and can radiate radio frequency energy and, if not installed and used in accordance with the instructions, may cause harmful interference to radio communications. However, there is no guarantee that interference will not occur in a particular installation. If this equipment does cause harmful interference to radio or television reception, which can be determined by turning the equipment off and on, the user is encouraged to try to correct the interference by one or more of the following measures:

- Increase the separation between the equipment and receiver.
- Connect the equipment into an outlet on a circuit different from that to which the receiver is connected.
- Consult the dealer or an experienced radio/TV technician for help.

This device complies with Part 15 of the FCC Rules. Operation is subject to the following two conditions:

1. This device may not cause harmful interference, and
2. This device must accept any interference received, including interference that may cause undesired operation.

NOTICE CONCERNING FCC REGULATIONS:

You are cautioned that changes or modifications not expressly approved by the part responsible for compliance could void the user's authority to operate the equipment.

This unit does not exceed the Class B limits for radio noise emission from digital apparatus set out in the radio interference regulations of the Canadian Department of Communications.

This symbol means the equipment is a Class II or double-insulated electrical appliance. It has been designed in such a way that it does not require a safety connection to electrical earth.

DOUBLE INSULATED - When servicing use only identical replacement parts.

Correct Disposal of this product: This marking indicates that this product should not be disposed with other household wastes through the EU. To prevent possible harm to the environment or human health from uncontrolled waste disposal, recycle it responsibly to promote the sustainable reuse of material resources. To return your used device, please use the return and collection systems or contact the retailer where the product was purchased. They can take this product for environmentally safe recycling.

CAUTION: This product was intended to use for professional person, does not provide power management function. Once don't use/operate the equipment, please power off to save the energy.

IMPORTANT!: Since digital circuitry may cause interference to other radio or television tuners nearby, switch this unit off when not in use or move it away from the affected radio/television tuner.

Correct cartridge alignment ensures the stylus is positioned properly relative to the grooves on the record. Incorrect alignment can cause distortion and can also cause unwanted wear and tear on your stylus. Follow the instructions below to ensure your cartridge is mounted correctly.

A video of the cartridge installation and alignment process is available at

1. Cut out the Cartridge Alignment Protractor* and carefully cut out the spindle hole (S). *See beside for cutout.
2. Place the protractor on the spindle.
3. With the stylus protector removed, gently place the stylus on point A.
4. Rotate the cartridge so that the sides of the cartridge are parallel with the grid lines (C).
5. Place the stylus on point B and confirm the sides are parallel with the grid lines (D).
6. If the cartridge sides are not parallel at point B move the cartridge forward (fig.1) or backward (fig.2) and repeat steps 4-6 until the sides are parallel at both points.

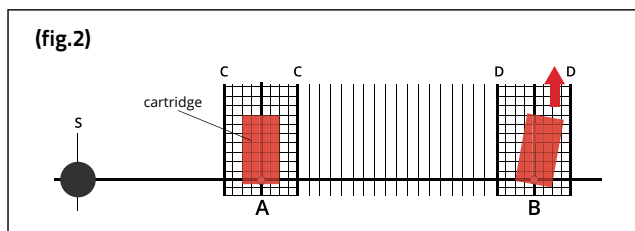
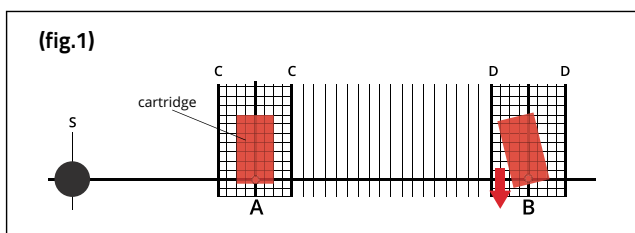

Cartridge Alignment
Protractor Cutout

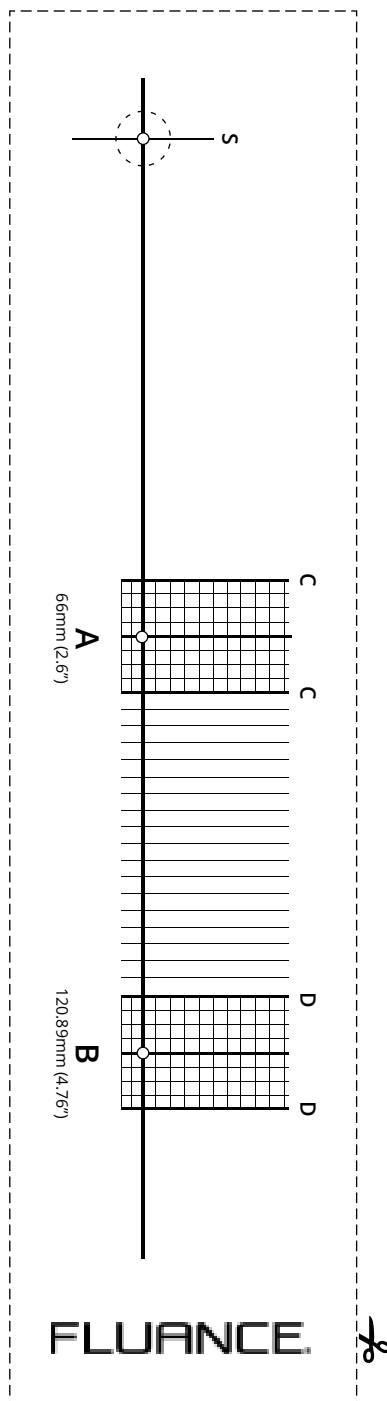

Fluance.com